

## Uponor Metallic Pipe PLUS 16 – 20 mm

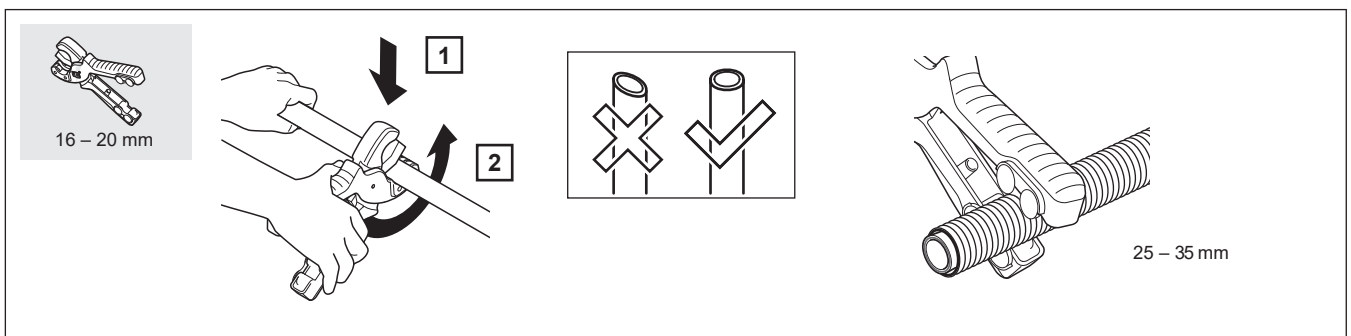

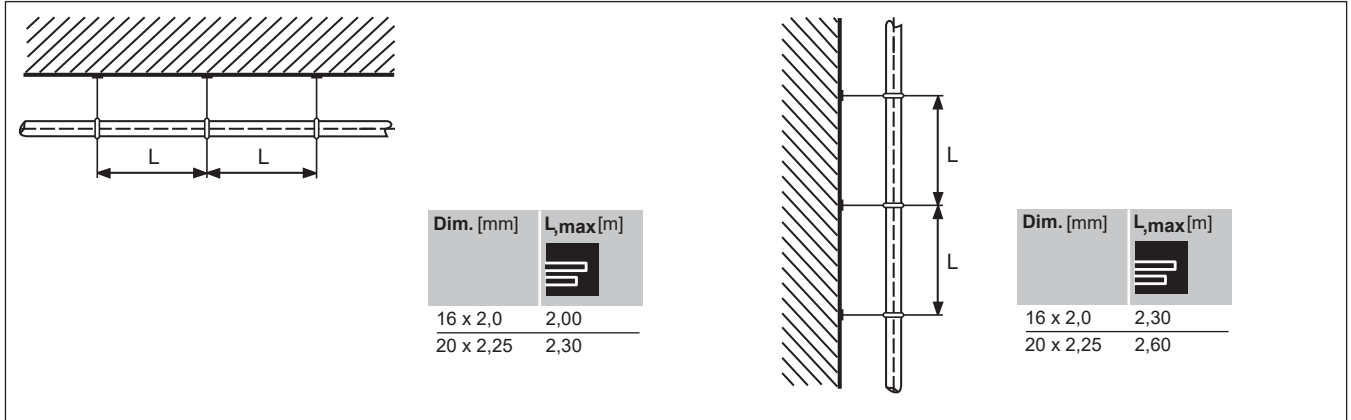
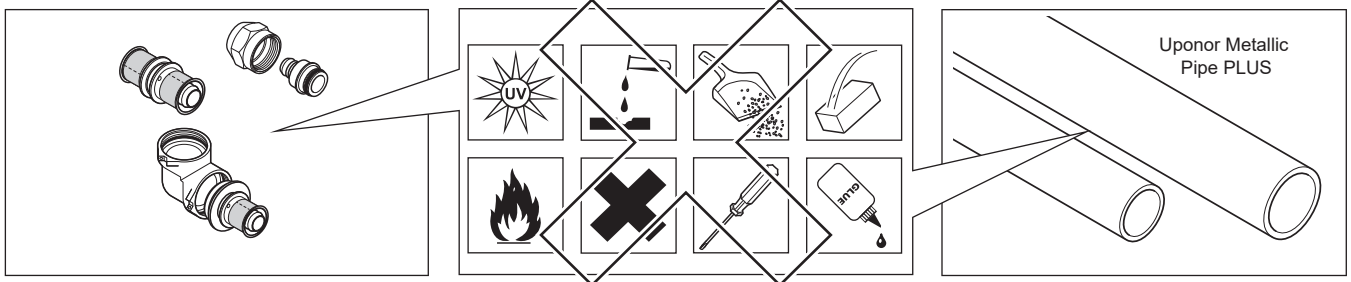

$d_a$ [mm]	$R_{min}$ [mm]
16	80
20	100

$d_a$ [mm]	$R_{min}$ [mm]
16	64
20	80

$d_a$ [mm]	$R_{min}$ [mm]
16	46
20	80

$$\Delta l \text{ [mm]} = \Delta \vartheta \text{ [K]} \cdot 0,025 \left[ \frac{\text{mm}}{\text{m} \cdot \text{K}} \right] \cdot L \text{ [m]}$$

$$BS \text{ [mm]} = 30 \cdot \sqrt{d_a \text{ [mm]} \cdot \Delta l \text{ [mm]}}$$

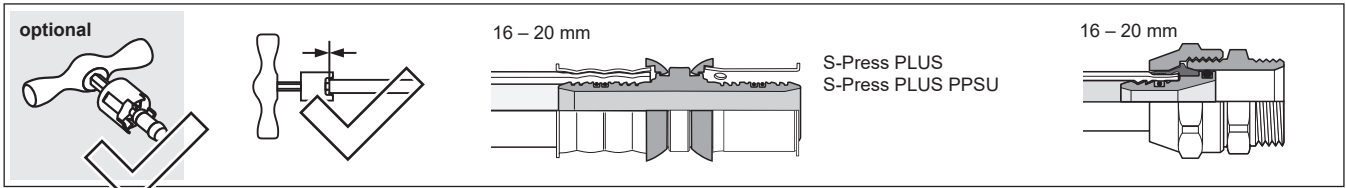
	UP110 UP75	UP75 EL	Mini2 Mini	
 S-Press PLUS	16 - 20		16 - 20	-
 S-Press PLUS PPSU	16 - 20		16 - 20	-
 RS	16 - 20		16 - 20	-
	-		-	16 - 20



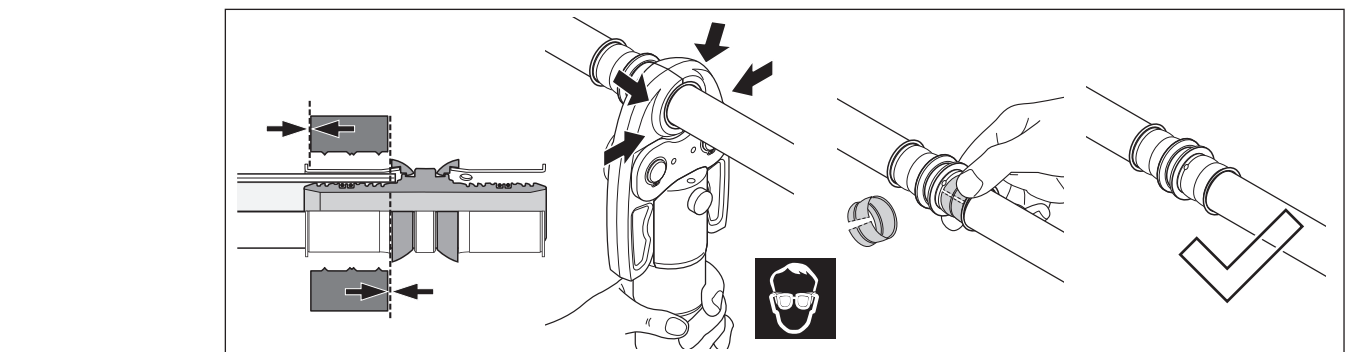
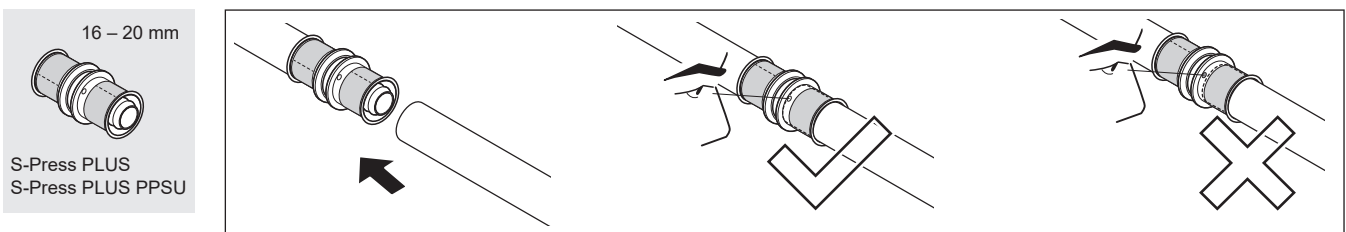

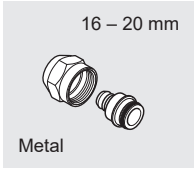
**1**

Fitting Dim.	X [mm]
16 – ½"	8
20 – ½"	10

Fitting Dim.	X [mm]
16 – ¾"	10
20 – ¾"	10

Fitting Dim.	X [mm]
16 – M 22	9
16 – M 24	9
16 – ½"	9
Geberit	

**2**

**3**

**4**



Nm

STOP

STOP

pH ≥ 12,5

